

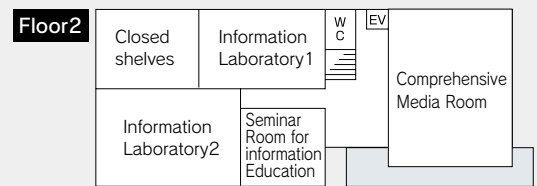

▲ Library Building

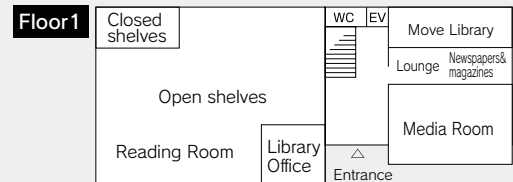

Floor layout



## 1. Users

- Students and staff
- Members of the public

## 2. Facilities available

### Students and staff can use

- All the facilities in the building and electronic journals on the Web.

### Members of the public can use

- All the facilities on Floor 1.

## 3. Loan quotas and periods

### Students

- Up to 5 books
- 1 week

### Staff

- Up to 10 books
- 4 weeks

### Members of the public

- (Apply for membership at the Reception Desk.)
- Up to 5 books
  - 2 weeks

## 4. Facility organization

### Floor 1

- Library Office
- Reception Desk
- Reading Room (Silence required)
  - with large desks for 87 readers 12 desks for self use,
  - 10 computers for book search and Internet surfing,
  - and audio-visual materials.
- Media Room (Chatting allowed)
  - with tables for 10 and desks for 20.
- Newspapers & Magazines
- Open Shelves
  - 29,000 volumes
- Closed Shelves
  - 44,000 volumes
- Extra long loans to staff offices
  - 10,000 volumes
- Women's Toilet
- Toilet for the Disabled
- Elevator
- Book Return Box (at the Entrance)



◀ Reading Room

## Floor2

- Comprehensive Media Room
- Information Laboratory1
- Information Laboratory2
- Seminar Room for Information Education
- Server Room
- Men's Toilet
- Elevator



▲ Comprehensive Media Room

## 5. Facilities for the Disabled

(Ask for help at the reception.)

## Floor1

- Parking spaces in front of the Entrance
- Wheelchair ramps
- The aisle between shelves is wide enough for two wheelchairs to pass.
- Toilet for the Disabled
- Elevator

## 6. Opening Hours

- Regular Session Periods
  - Weekday 9:00am-8:00pm
  - Saturday 10:00am-5:00pm
  - Sunday Closed
  - Holiday Closed

## 7. Summer, Winter & Spring Vacations

Weekday 9:00am-5:00pm  
Saturday Closed  
Sunday Closed  
Holiday Closed  
August 13-16 Closed  
December 28-January 4 Closed

## 8. Services

- Issues and returns
- Library book search (You can find books in libraries online.)
- Oita Prefecture libraries book search (You can find books in Oita Prefecture libraries online.)
- Reference service (We will help you search for information.)
- Electronic journals, etc: CiNii, ScienceDirect(EJ), MathSciNet, JDreamII and Science

## 9. Publications

- *The Library Report*
- *Mosaku* , a collection of book reports by students, published annually
- *The Library Newsletter*
- *Memoirs of Oita National College of Technology*

## 10. Events

- The Reading Circle, held twice a year
- The Book Report Competition
- The Bookworm Awards
- The Book Hunting, held twice a year

## 11. The Student Librarian Committee

Every semester, two students are elected from each class to work on the committee as student librarians. They are actively involved in launching events, compiling publications, etc. From time to time, they make a survey on books and magazines needed, and the result is taken into consideration in purchasing library materials. Other important roles are to inform students of newly-purchased books and encourage them to make better use of the Library.

### For further information

- Phone : +81(0)97-552-6084
- Email : tosho@oita-ct.ac.jp
- Address : 1666 Maki, Oita-shi, Oita 870-0152

### · The Library Website

URL : [http://www.oita-ct.ac.jp/library/lib\\_index.html](http://www.oita-ct.ac.jp/library/lib_index.html)